

# Five Years of Institutional Governance at the University of Oregon

**University Senate**

January 8, 2020



# Governance, Leadership and Finance



# Governance

---

- Established governance foundation
  - Board of Trustees assumed authority in 2014
  - Migrated, created policies and rules
  - Wrote bylaws, mission statement
  - Established shared services, treasury and internal audit
- Earned strong bond rating
- Hired new president



# Leadership and Governance

---

- Hired new administrative and academic leadership team
- Enhanced administrative infrastructure
- Completed Excellence Strategic Framework
- Implemented CBA with United Academics
- Rebuilt relationship with University Senate
- Redesigned IT infrastructure and technology



# Finance

---

- Created new academic funding system and budget model
- Advocated for and achieved growth in state funding
- Managed significant PERS and benefits increases not covered by state funding, but with impact on tuition, programming and staff
- Developed long-term financial plan
- Strategically grew enrollment without diminishing student quality



# Philanthropy

---

- Raised \$2 billion
  - 67% academic – 33% athletics
  - Includes \$373.8 million for student support
  - Grew endowment by 27% to \$940+ million
- Extended campaign to \$3 billion



# Academic and Research Excellence



# Phil and Penny Knight Campus for Accelerating Scientific Impact

- Faculty generated concept
- \$500 million cornerstone gift
  - \$70 million state of Oregon
  - \$20 million additional philanthropy
- Created strategic plan
- Hired director, four faculty members, staff
- Collaborating with OSU and OHSU on degree programs and research

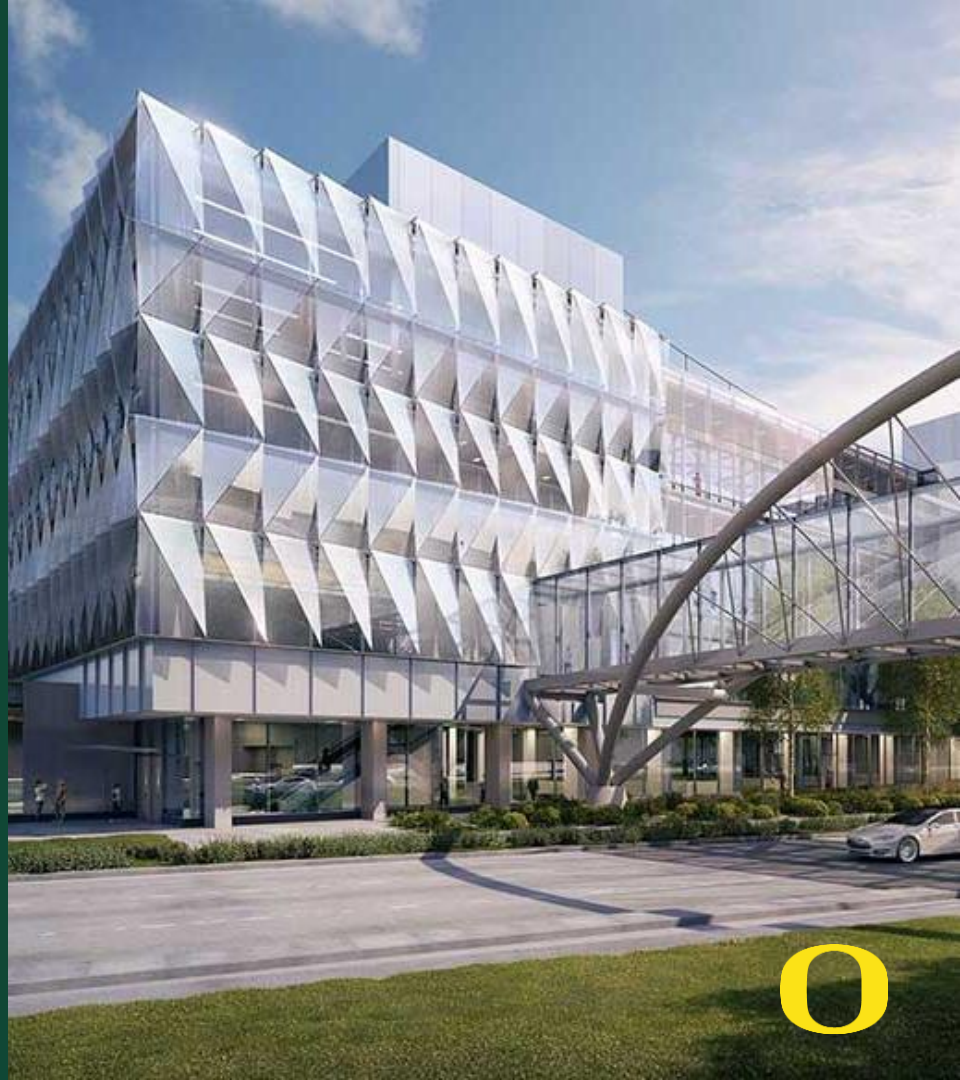

# Research Excellence

---

- Increased tenure-related faculty by +72 net positions
- Completed cluster initiative hiring
- Launched new research initiatives in schools and colleges
- Boosted research and development expenditures by 20%
  - New awards for 2019 jumped 57%
- Renovated laboratory and research space:
  - \$60 million invested in renovating older laboratories
  - 200,000 sq. ft. of laboratory space built or renovated once Knight Campus is built



# Teaching and Curriculum

- Improved focus on quality instruction
  - Revised instructor evaluations
  - Established new core learning outcomes for courses
- Added new degree programs and minors
- Reduced student-teacher ratios to 17:1
- Launched online education initiative



# Student Access and Success



# Student Access

---

- Invested in recruitment programs for underrepresented and first-generation students
- Boosted scholarship assistance to Oregonians by 37%
- Doubled Stamps Scholarship program
- Expanded PathwayOregon by 40%,
  - Served 6,700+ students since inception



# Student Success

- Invested in nearly 20 student success initiatives
  - Expanded first-year experience and undergraduate research opportunities
  - Removed some curricular barriers to 4-year graduation
  - Improved support for underrepresented students
  - Integrated advising, career counseling and tutoring in new Tykeson Hall
  - Hired two dozen additional advisors



# Student Success

Four-year graduation rate up 10+ points

**60.7%**

UP FROM 49.9%

4-YEAR RATE

**74.5%**

UP FROM 71.6%

6-YEAR RATE



# Diversity, Equity and Inclusion



# Diversity, Equity and Inclusion

---

- Created IDEAL Framework and Diversity Action Plans
- Enacted implicit bias training and active recruitment process
- Increased first-year underrepresented minority enrollment from 27% to 34%
- Modestly increased number of faculty of color from 18% to 19%
- Enacted new multi-cultural curriculum requirement



# Diversity, Equity and Inclusion

- Built new Lyllye Reynolds-Parker Black Cultural Center
- Created African American Workshop and Lecture Series
- New academic residential communities (Indigenous, Black, Latinx)
- Launched Black studies program
- Renamed Dunn Hall to Unthank Hall



# Student Experience



# Student Experience

- Built Kalapuya Ilihi Hall and renovated Bean Hall, planning new housing
- Renovated and expanded Student Rec Center, Erb Memorial Union, Health Center, Price Science Commons and Research Library, Tykeson Hall
- Revamped Fraternity and Sorority Life support
- Invested in Title IX services, revised policies to encourage reporting and increase support



# Challenges and Opportunities

---

- Financial stability
- Strategic investments in a time of budgetary scarcity
- National skepticism about higher education

